

ROOF STRUCTURE	
-	DIMENSIONAL SHINGLES
-	15# FELT
-	1/2" O.S.B. ROOF SHEATHING WITH H CLIPS
-	ICE & WATER SHIELD MIN 24" UP FROM INSIDE OF WALL
-	ROOF TRUSSES @ 24" O.C.
-	R-49 MIN. CEILING INSULATION
-	5/8" CEILING DRYWALL - SMOOTH FINISH

EXTERIOR WALLS (HOUSE)	
-	EXTERIOR VINYL AND LP SMARTSIDE SIDING
-	7/16" OSB SHEATHING
-	#2 BTR 2 x 6 STUDDING @ 16" O.C.
-	(R-20) MIN. WALL INSULATION
-	INSUL. AROUND ALL WINDOW & DOOR OPENINGS
-	1/2" DRYWALL @ INTERIOR
-	INTERIOR PAINT

STAIR SPECS	
-	(3) 2 x 12 STRINGERS
-	1 1/8" PARTICLE BOARD TREADS
-	1x8 PINE RISERS (RIP TO FIT)
-	6'-8" MINIMUM HEADROOM
-	32" TO CENTER OF HANDRAIL

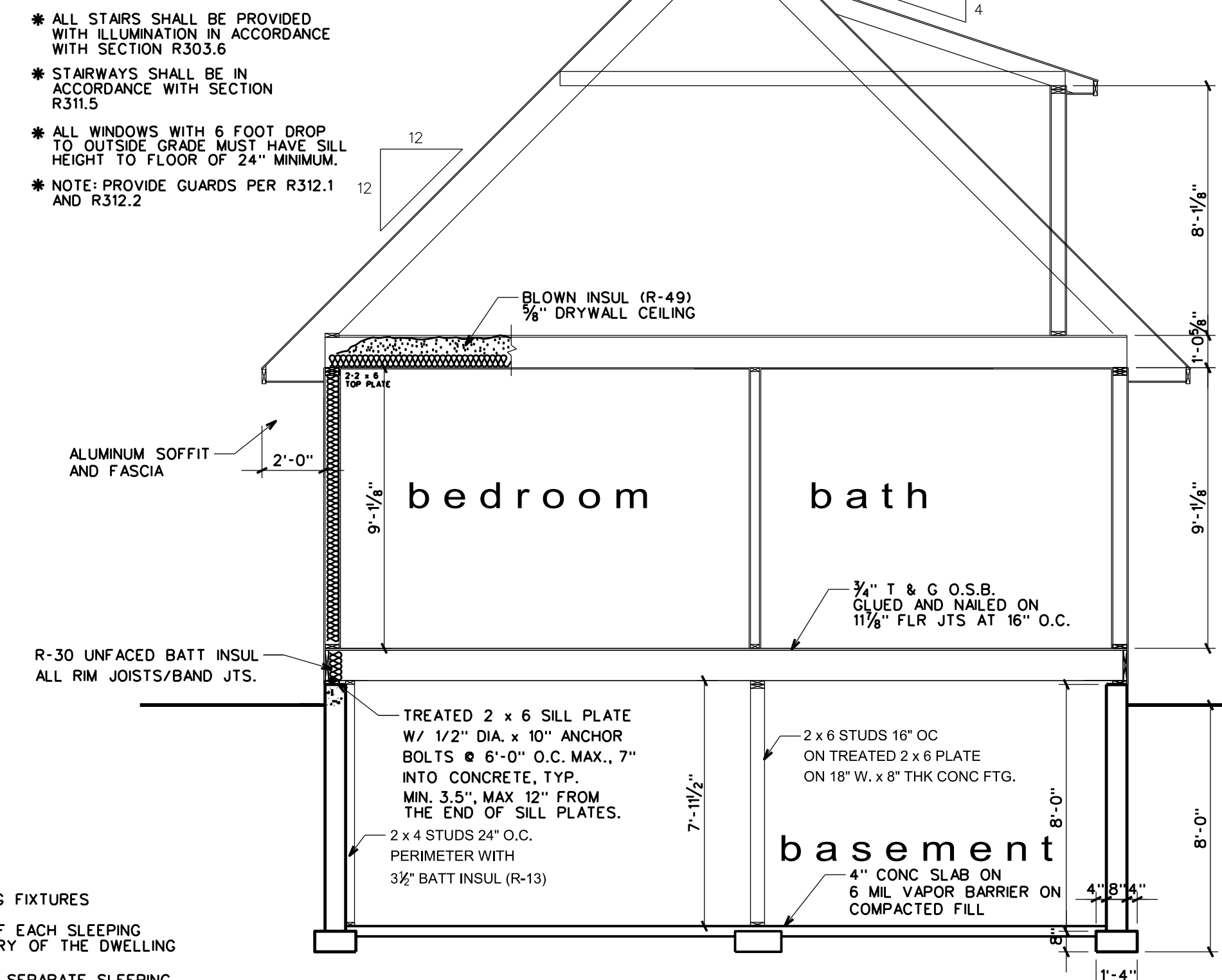

- general notes:**
- A MINIMUM OF 75% OF THE LAMPS IN PERMANENTLY INSTALLED LIGHTING FIXTURES SHALL BE HIGH-EFFICIENCY LAMPS, SEC.404, 2009 IECC.
 - SMOKE DETECTORS ARE REQUIRED IN EACH SLEEPING ROOM, OUTSIDE OF EACH SLEEPING AREA IN THE IMMEDIATE VICINITY OF THE BEDROOMS AND IN EACH STORY OF THE DWELLING INCLUDING BASEMENTS, SEC.R314.3, 2009 MRC.
 - CARBON MONOXIDE DETECTORS SHALL BE INSTALLED OUTSIDE OF EACH SEPARATE SLEEPING AREA IN THE IMMEDIATE VICINITY OF THE BEDROOMS, SEC.R315, 2009 MRC.
 - TRUSSES SHALL BE CONNECTED TO WALL PLATES BY THE USE OF APPROVED CONNECTORS HAVING A RESISTANCE TO UPLIFT OF NOT LESS THAN 175 POUNDS AND SHALL BE INSTALLED IN ACCORDANCE WITH THE MANUFACTURER'S SPECIFICATIONS.
 - FLASHING IS REQUIRED AT ALL HORIZONTAL TRIM PROJECTIONS AND ABOVE THE WINDOW AND DOOR TRIMS.
 - SAFETY GLAZING IS REQUIRED IN FIXED AND SLIDING PANELS OF SLIDING DOOR ASSEMBLIES IN DOORS AND ENCLOSURES FOR BATHTUBS AND SHOWERS, IN SWINGING DOORS AND IN AN INDIVIDUAL FIXED PANEL ADJACENT TO A DOOR.
 - BATHROOMS SHALL HAVE A WINDOW OR BE MECHANICALLY VENTED.
 - WINDOW AND DOOR HEADERS SHALL COMPLY WITH TABLE R502.5(1)
 - PRESCRIPTIVE ENERGY CODE COMPLIANCE.
 - HANDRAILS REQ'D AT ALL STAIRS WITH 4 OR MORE RISERS.

0 4 8 12 16
P.I.N.: 61-27-452-000-0067-00